



PRESENTS THE

# eco series<sup>TM</sup>

Through-The-Wall Single Package Vertical  
Product Line Offering Various Energy Sources  
*For Any Multi-Family Application.*

eco series  
FRESH-PAK<sup>®</sup>

eco series  
THERMA-PAK<sup>®</sup>

eco series  
COOL-PAK<sup>®</sup>

eco series  
AQUA-PAK<sup>®</sup>

FIRST CO. P.O. BOX 270969 - DALLAS, TEXAS 75227  
PH. (214) 388-5751 | FAX (214) 388-2255  
WWW.FIRSTCO.COM



## Single Package Vertical Unit

*With ERV*

- **Straight Cool and Heat Pump and Hydronic Heating**
- **3/4 through 2 tons**
- **Up to 10 kW Electric Heat**
- **11.00 EER**



Runs quietly in the background to provide constant fresh air



Runs separately from the main HVAC system



Minimal additional moving parts



Reduces the running time of the HVAC main unit



Offers fresh air comfort even when the main HVAC unit is not running



## HOW IT WORKS DURING SUMMER MONTHS

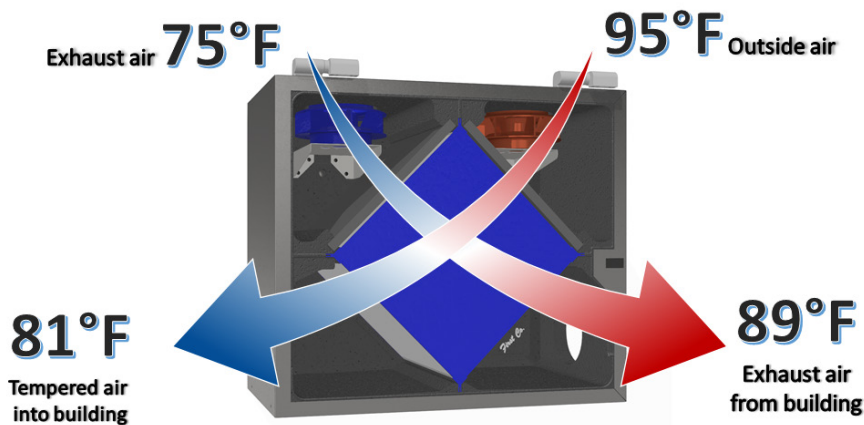

## HOW IT WORKS DURING WINTER MONTHS

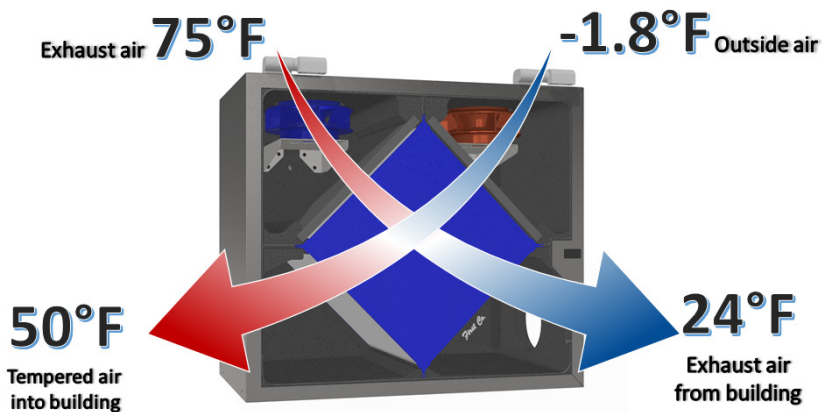

# What is ERV?

ERV uses a plate heat exchanger to transfer temperature (sensible energy) and moisture (latent energy) from waste air to incoming ventilation air. ***It will cool the air in the warmer months and warm the air in the coldest months.***

# ERV Venting Options



Fresh air power venting independent of the air conditioning or heating system.

## Fully electronic controls with:

- ✓ On board scheduler
- ✓ Ventilation boost mode
- ✓ Frost protection modes
- ✓ App compatible
- ✓ Commissioning checklist
- ✓ Trouble shooting/system check
- ✓ Optional air quality sensor to automatically adjust for humidity or CO2 concentrations.

### ERV intake duct

With controls for freeze protection

- Supply lock out
- Modulating supply from Hi to Lo

*Other options:*

- Supply lock out

### ERV exhaust duct

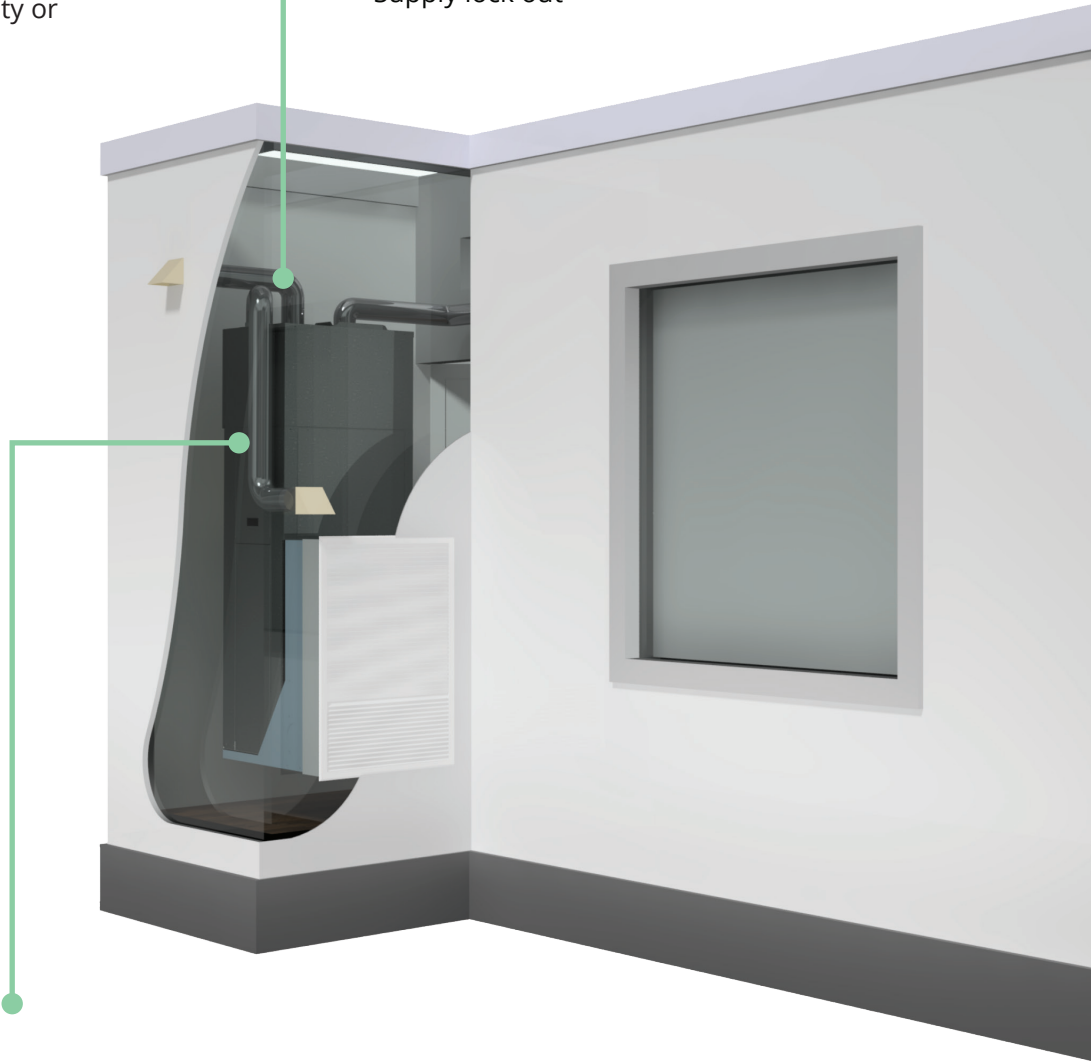



The ERV's separate "smart controller" creates and maximizes overall comfort while meeting all required comfort needs. It operates independently with an onboard scheduler. It is equipped with outside air pre-filters to catch dust and debris before supplied to the space.

**eco**series  
FRESH-PAK<sup>™</sup>

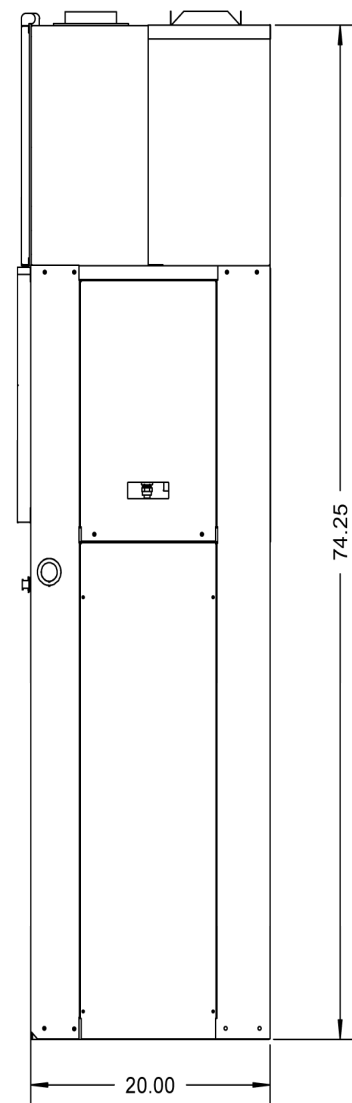
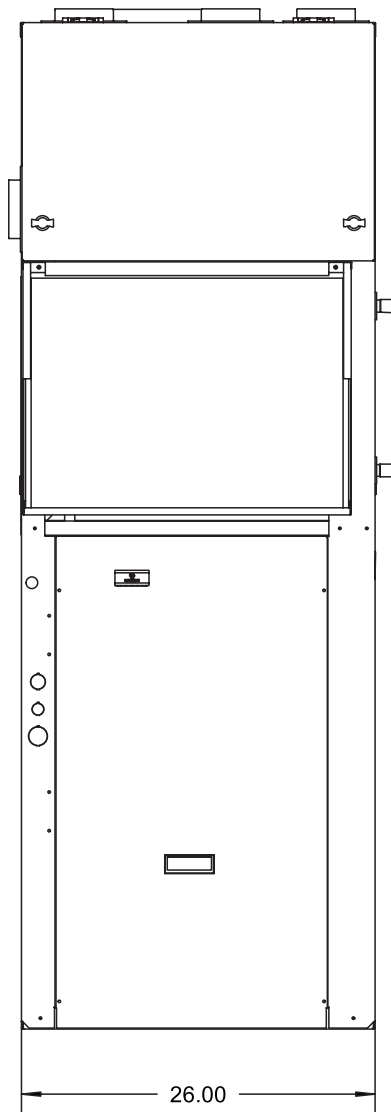
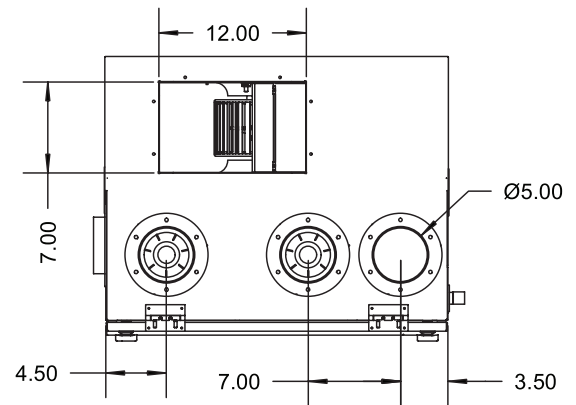

# eco series

## THERMA-PAK<sup>TM</sup>

### Single Package Vertical

#### Gas Unit

- **81% Thermal Efficiency**
- **9,000 through 30,000 BTUH Cooling Capacity**
- **Up to 60,000 BTUH Heating Capacity**
- **UP to 12.0 EER**



Self-contained packaged units with gas-fired heating and electric cooling



Pre-wired and pre-charged from factory



Eliminates the need for outdoor condensing section units, line-sets and separate ventilation



Direct vent / Sealed combustion for safe and reliable performance, and longer heat exchanger life



This product is certified by ETL to be installed without a return air duct. Check local building codes for compliance requirements and consult with the manufacturer.





High efficiency scroll and rotary compressors

High efficiency ECM indoor blower with multiple speed taps for precise airflow selection

High efficiency ECM condenser fan motor to improve system efficiency

Architectural louvers available

Adjustable flue pipe for various sleeve depths

Stainless steel heat exchanger for corrosion resistance

Dual inlet indoor blower to lower fan speed, improve efficiency and reduce noise

Insulation inside of cooling compartment to improve cooling performance and reduce noise

Double isolated compressor mount to lower compressor noise and vibration



## TOP VIEW

### Detail A

20,000 to 40,000 BTUH

### Detail B

50,000 to 60,000 BTUH

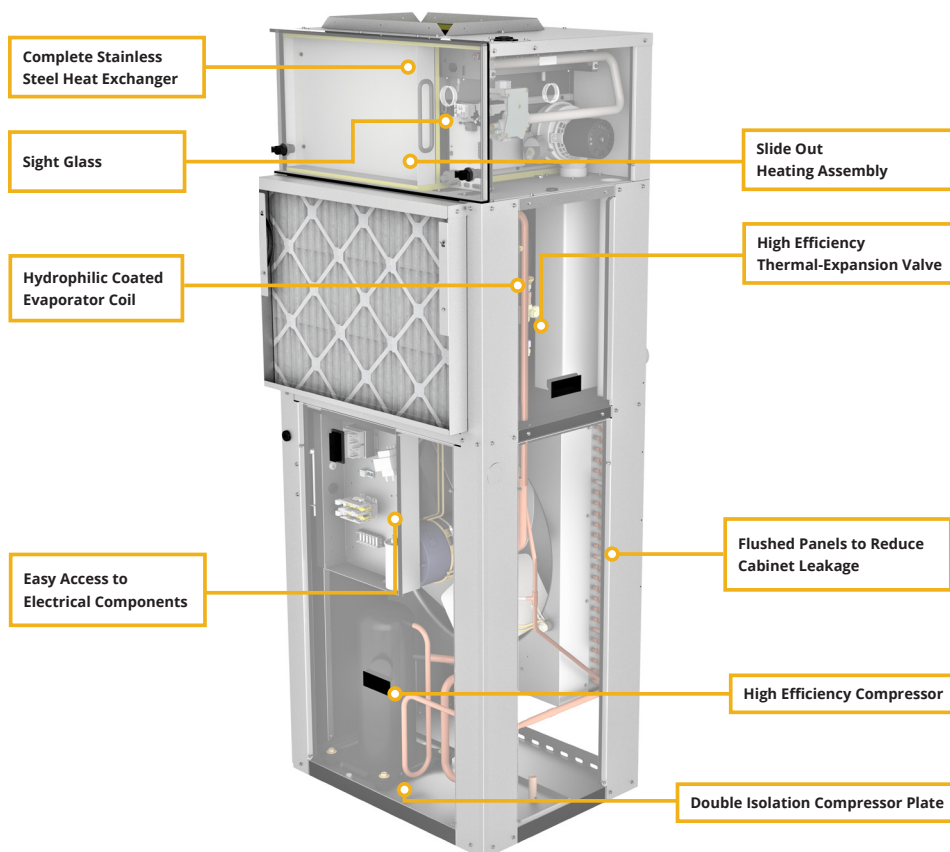
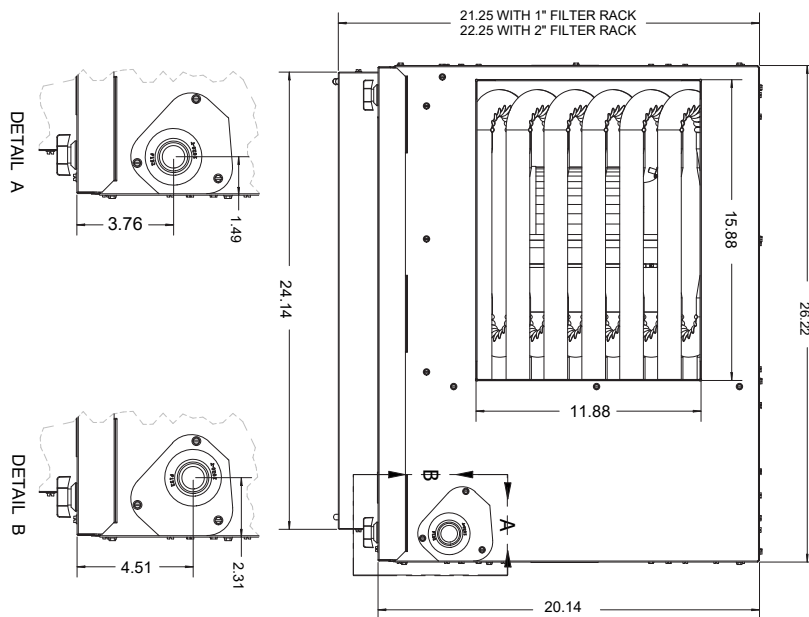



**FRONT VIEW**

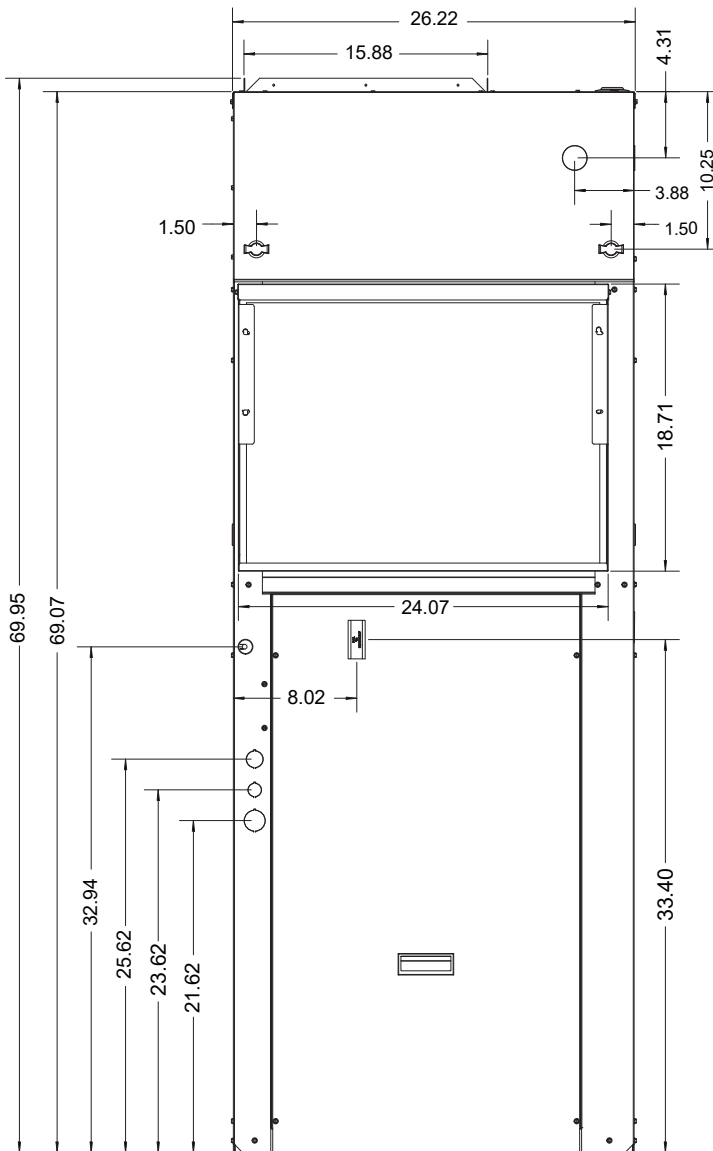

**RIGHT VIEW**

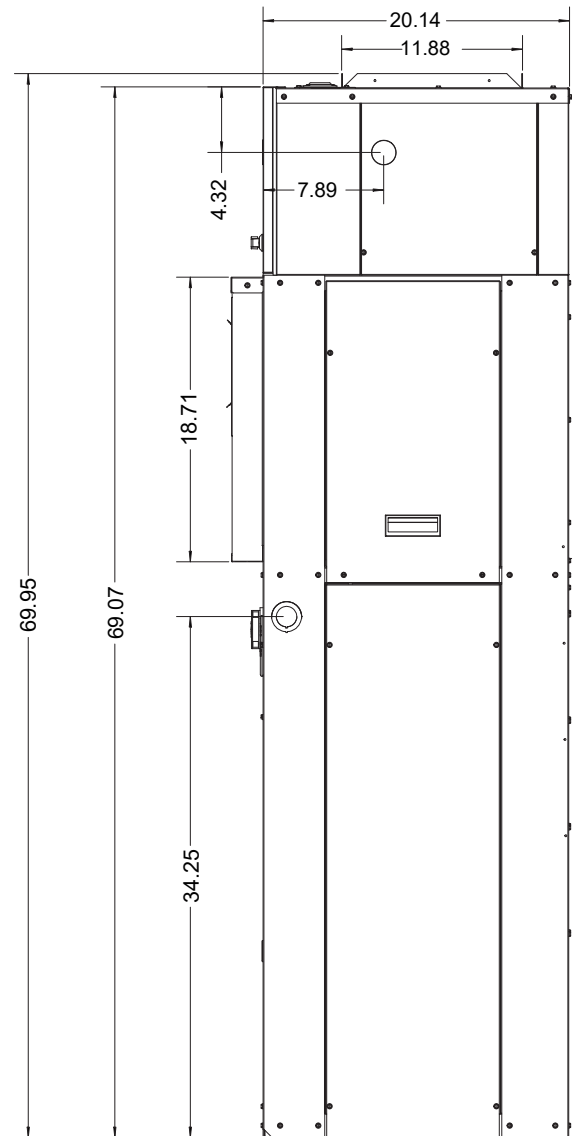



## Single Package Vertical Unit

- Straight Cool and Heat Pump
- 3/4 through 2.5 tons
- Up to 10 kW Electric Heat
- **NEW 2.5 TON**
- **11.0 EER!!**

The **ECO Series Cool-Pak** is a compact, through-the-wall single package vertical HVAC unit that delivers conditioned air from a single unit to multiple rooms. The **Cool-Pak** is available in straight cool or heat pump models.

Having a small footprint allows the **ECO Series** to use a minimal amount of floor space. The **ECO Series** installs easily into a closet having an exterior wall. A standard wall mounted thermostat controls the unit. Applications for the **ECO Series** include:

- ✓ **Hotels / Motels**
- ✓ **Student housing**
- ✓ **High rise apartments / Condominiums**
- ✓ **Manufactured / Modular buildings**
- ✓ **Assisted Living / Independent care facilities**





# Standard Features

Completely pre-charged with environmentally friendly R-410A refrigerant

Weight-supporting, single piece wall sleeves (except side access sleeves) for various wall thicknesses from 5" to 20"

Easy access for in-place service of most components

Sleeves have primary condensate drain connection with secondary overflow to building exterior

Service disconnect

All sleeves are shipped with a weather guard

Adjustable fresh air damper

Completely insulated cabinet for sound attenuation and weather infiltration

No tool needed to replace the filter

Flush type exterior architectural grilles

Multi-function micro-processor board that includes the following functions:

- Evaporator coil low temperature protection
- Low ambient lockout
- ECM motor utilized on all models
- Random restart
- Compressor restart delay
- Fan-off delay in the cooling mode
- Low voltage fuse protection

# Optional Features

- Side access wall sleeves (rear access is standard)
- Custom painted exterior architectural grilles
- Hurricane grille / sleeve combinations
- Various louvered and non-louvered interior access panels
- Digital wall mount thermostats with high and low temperature limits

**eco**series  
COOL-PAK®

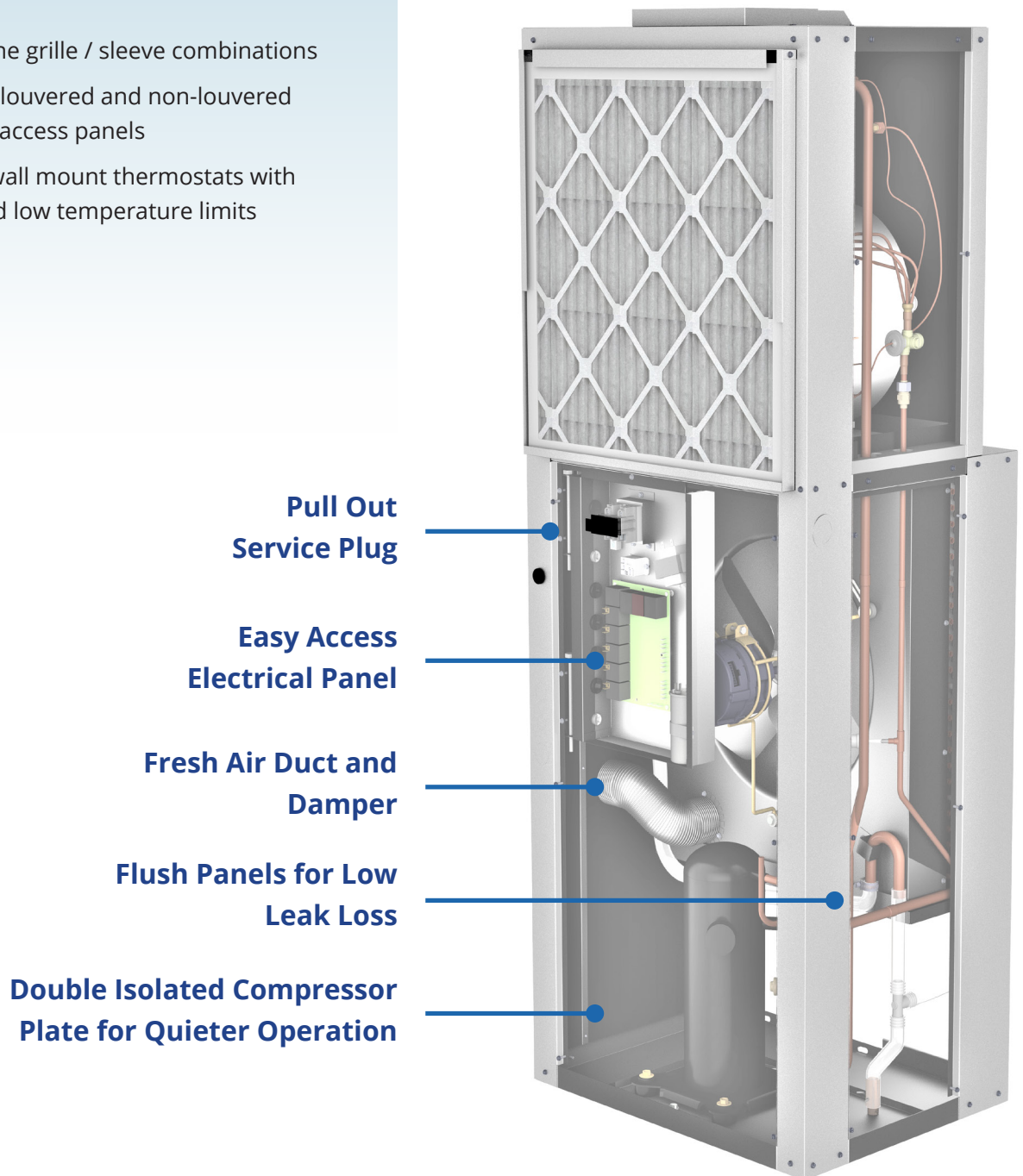

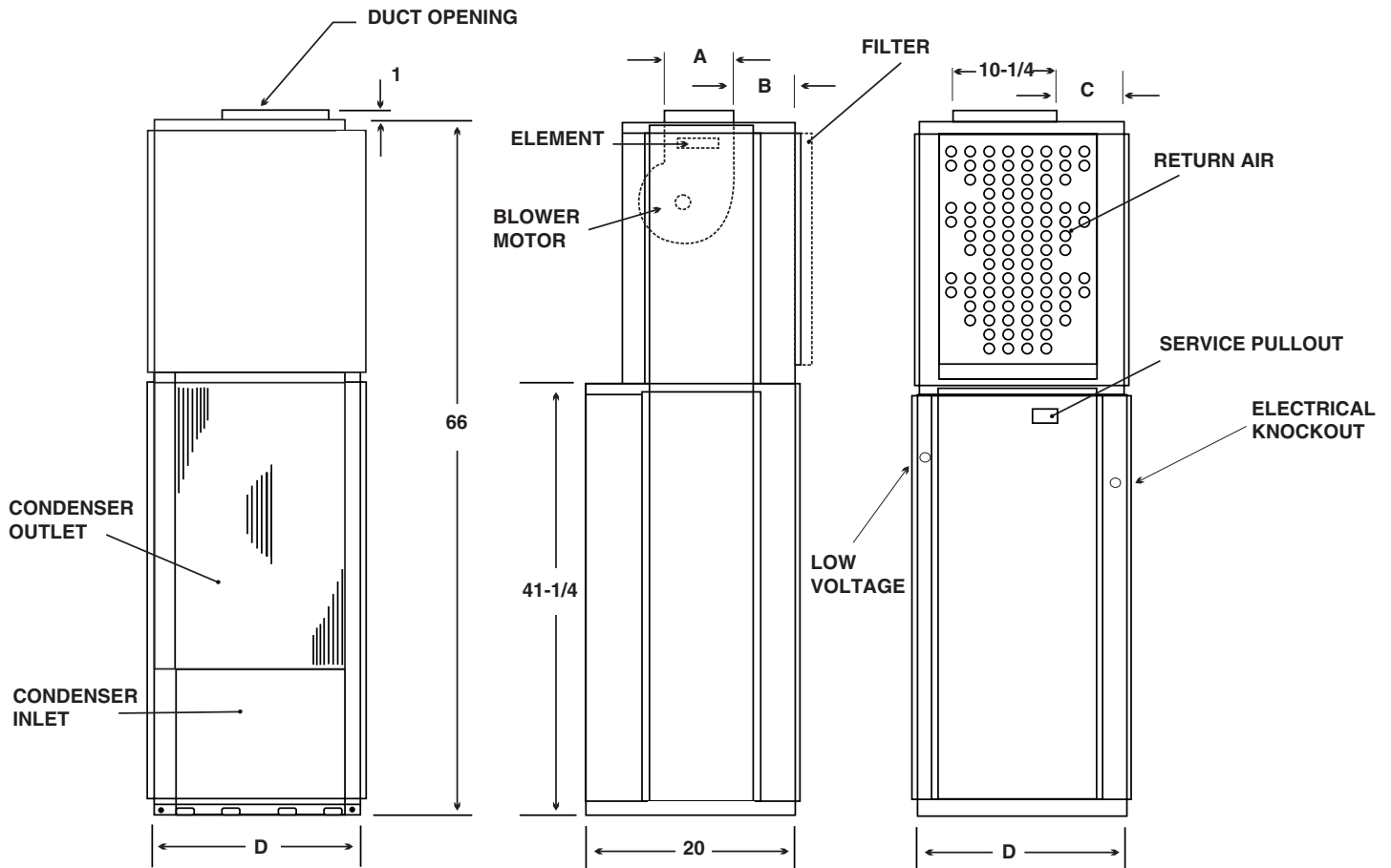

	A	B	C	D	FILTER
9,12,18	6-1/2	6-1/8	6-5/8	20	18 x 24 x 1
24,30	10	2-1/2	8	26	24 x 24 x 1

*small footprint* ——— *minimal floor space*



## Single Package Vertical Unit

- Cooling with Hot Water Heat
- .75 through 2.5 tons
- Up to 47,800 BTUH Heating

The **Eco-Series Aqua-Pak** is a compact, through-the-wall single package vertical HVAC unit that delivers conditioned air from a single unit to multiple rooms. Warm, efficient space heating is provided by connecting the hot water coil to a properly sized individual natural gas or oil fired water heater or to a boiler (for boiler applications, a motorized zone valve must be powered by an external voltage source).

Having a small footprint allows the **Eco-Series** to use a minimal amount of floor space. The **Eco-Series** installs easily into a closet having an exterior wall. Like your home, a standard wall mounted thermostat controls the unit. Applications for the **Eco-Series** include:

- ✓ **Hotels / Motels**
- ✓ **Student housing**
- ✓ **High rise apartments / Condominiums**
- ✓ **Manufactured / Modular buildings**
- ✓ **Assisted Living / Independent care facilities**



# Standard Features



Completely pre-charged with environmentally friendly refrigerant

No tool needed to replace the filter

Easy access for in-place service of most components

Weight-supporting, single piece wall sleeves (except side access sleeves) for various wall thicknesses from 5" to 20"

Service disconnect

Sleeves have primary condensate drain connection with secondary overflow to building exterior

Completely insulated cabinet for sound attenuation and weather infiltration

All sleeves are shipped with a weather guard

Adjustable fresh air damper

Multi-function micro-processor board that includes the following functions:

- Evaporator coil low temperature protection
- Low ambient lockout
- ECM motor utilized on all models
- Random restart
- Compressor restart delay
- Fan-off delay in the cooling mode
- Low voltage fuse protection



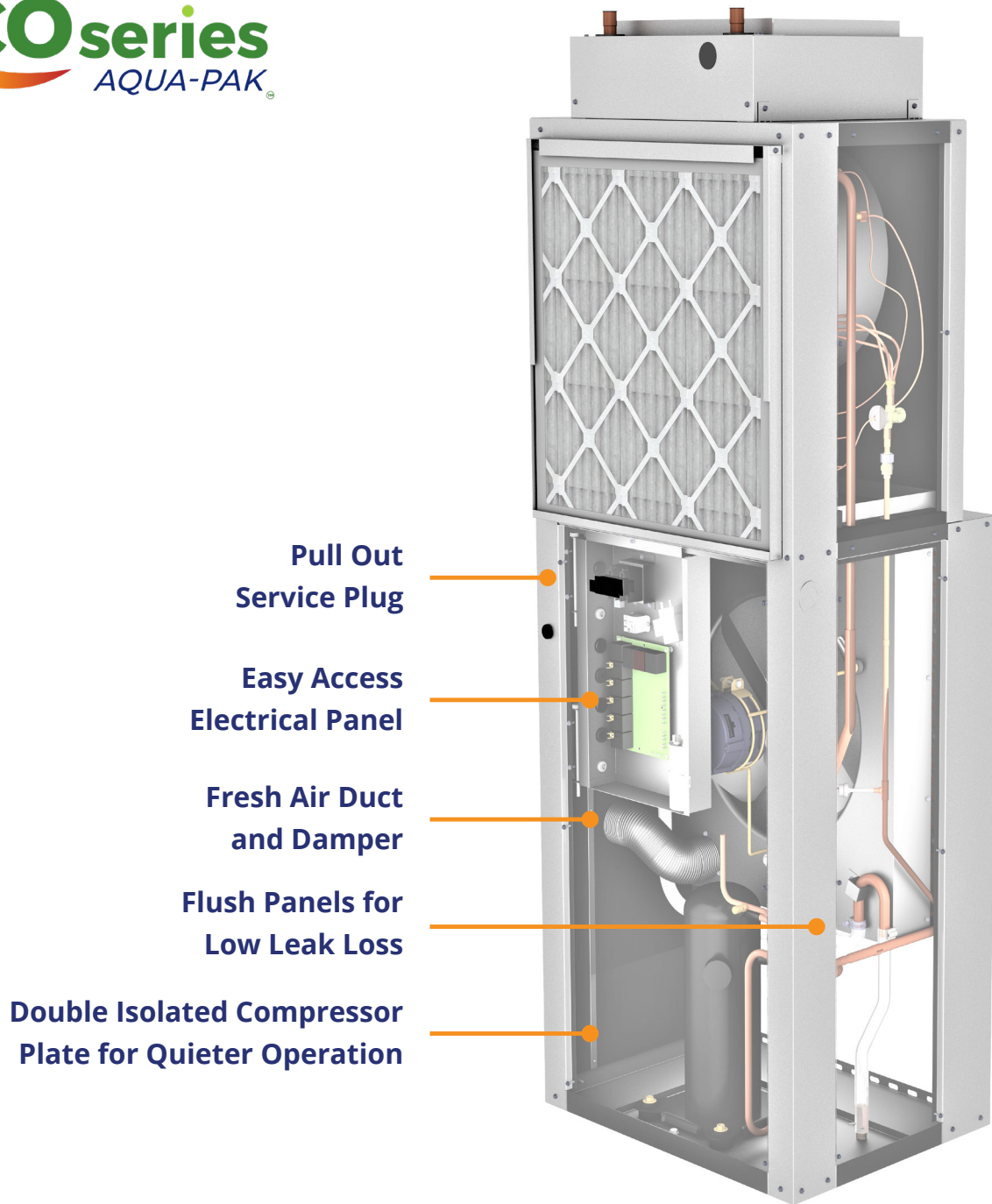

## Optional Accessories

- ▶ Hurricane grille / sleeve combinations
- ▶ Various louvered and non-louvered interior access panels
- ▶ Digital wall mount thermostats with high and low temperature limits
- ▶ "Flow control module" for connecting to water heaters (contact factory)

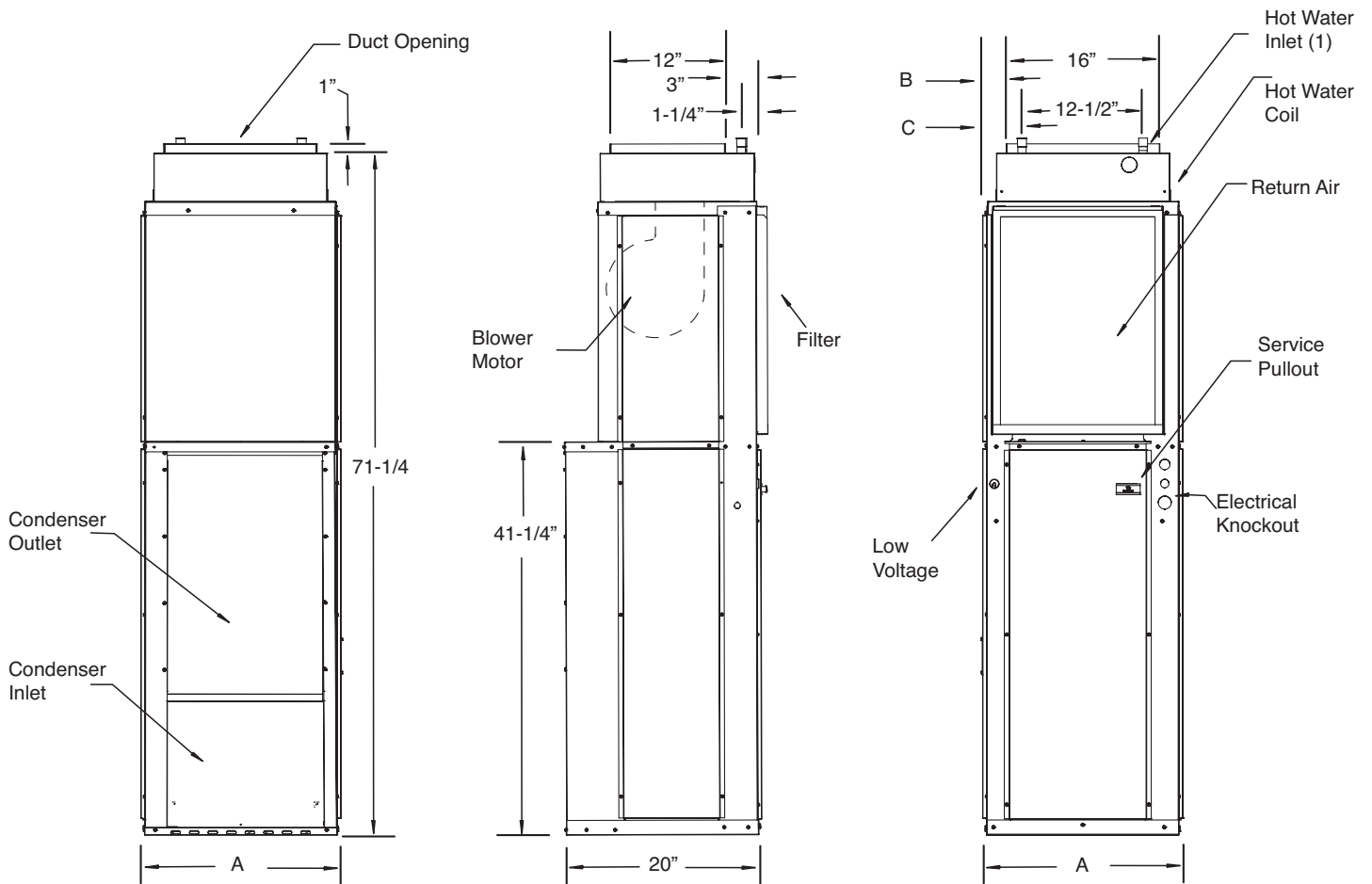

(1) Hot water coil connections are 7/8" O.D., Sweat

UNIT	A	B	C	FILTER
<b>9,12,18</b>	20	2	3-3/4	18 x 24 x 1
<b>24,30</b>	26	5	6-3/4	24 x 24 x 1

# NOTES

# eco series<sup>TM</sup>



eco series  
FRESH-PAK<sup>®</sup>



eco series  
THERMA-PAK<sup>®</sup>



eco series  
COOL-PAK<sup>®</sup>



eco series  
AQUA-PAK<sup>®</sup>



FIRST CO. P.O. BOX 270969 - DALLAS, TEXAS 75227  
PH. (214) 388-5751 | FAX (214) 388-2255  
[WWW.FIRSTCO.COM](http://WWW.FIRSTCO.COM)