

Wall Mount VERTICAL FAN COIL UNITS

1½ Ton thru 3 Ton Sizes



FIRST CO.

Series RME/Series RHE
Vertical Fan Coil
Economaster

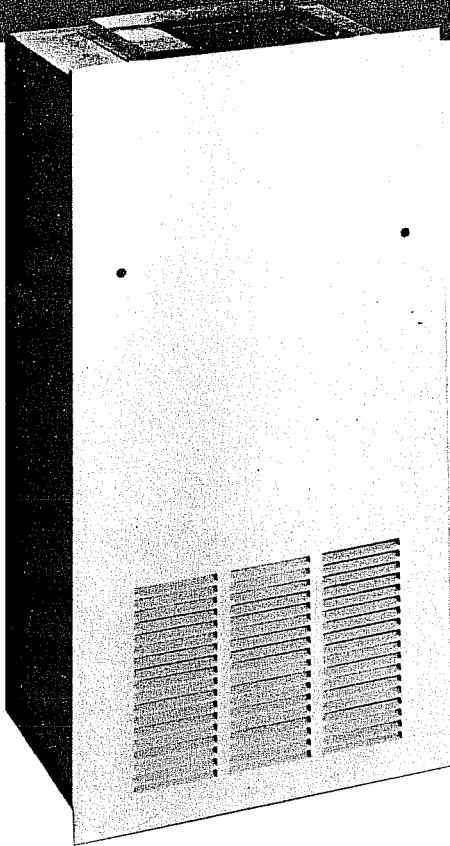

Space-Saving Wall-Recessed Vertical Fan Coil Units

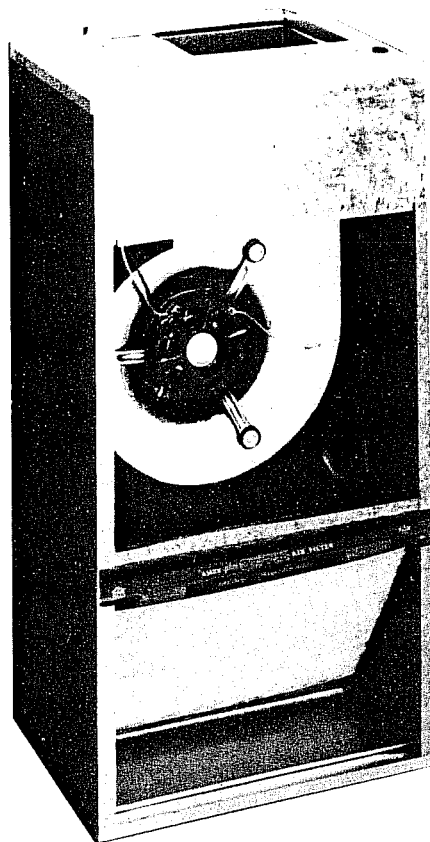

- Optimum low cost heating and cooling system.
- Wall-mounted — no closet is needed. Eliminates the need for dry wall, taping and bedding, painting, closet door, door framing, and hardware.
- Save on installation time and cost.
- Ease of maintenance — fully accessible from the front after installation for service and filter change.
- Quiet operation.
- Top performance — energy efficient.

WALL MOUNT ECONOMASTER SPECIFICATIONS

ECONOMASTER comes from the factory with a finished wall panel that quickly attaches to the unit and provides a return air grille and complete ready access to all unit components for servicing.

Direct expansion cooling 1½ to 3 ton sizes.

Resistance electric heating 3KW to 15KW.

Cabinet —

Constructed of heavy gauge galvanized steel with fully insulated interior surfaces.

Wall panel —

Galvanized steel construction with stamped return air louvers. Finished with durable baked-on off-white epoxy paint.

The exposed finished wall panel is shipped separately to be installed after the walls have been textured and painted.

The unit is shipped with a throwaway metal panel which protects the motor blower assembly until the finished panel is installed.

Drains —

A removable panel is provided at the bottom of the unit for easy access to the drain connection after installation.

Coils —

Fabricated of copper tubes mechanically expanded to highly efficient aluminum fins to maximize heat transfer. Capillary tubes, strainer, and sweat refrigerant connections are standard.

Electrical —

Completely factory wired, installation consists only of bringing power supply to the unit and running low voltage wiring to the thermostat.

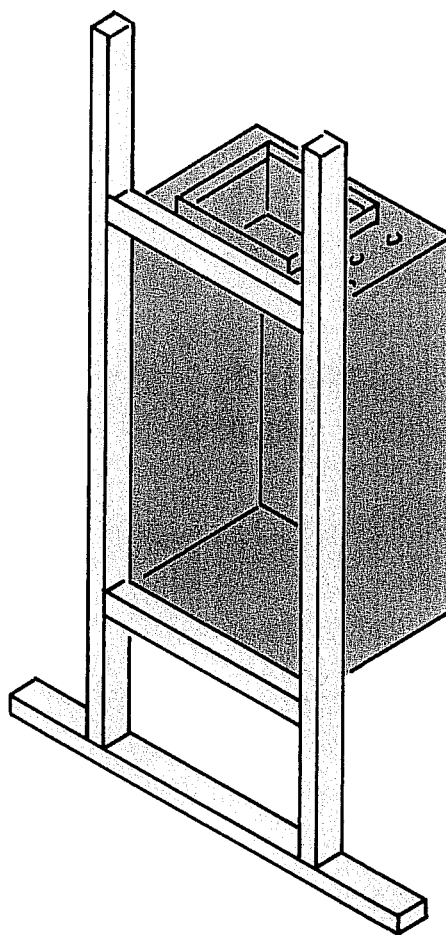

Silent Control System —

Heater elements are activated by silent sequencers — no banging contactors.

Heating elements are of top quality nickel-chromium wire. Coil diameters are enlarged to provide lower surface operating temperature and longer life.

All elements are provided with in-line fuse links as back-up to the UL required automatic reset thermal overloads to afford the maximum in safety.

Motors/Blowers —

Dynamically balanced blower motor assembly assures smooth, quiet performance.

Motors are low speed 1050 RPM for extremely quiet operation. These permanent split capacitor type (PSC) motors provide the lowest possible energy consumption.

Oil tubes are provided for periodic oiling to insure long life.

Filters —

A standard sized throwaway filter is provided and installed with all models.

BLOWER DATA

UNIT MODEL	FAN SPEED	DUTY	VOLTS	CFM VS. STATIC PRESSURE					
				0.05	0.10	0.15	0.20	0.25	0.30
18RME	HIGH	COOL	230	760	740	720	705	685	670
	LOW	HEAT		600	590	580	570	560	555
24RME	HIGH	COOL	230	1020	1000	980	960	930	905
	LOW	HEAT		830	815	800	785	765	745
30RME	HIGH	COOL	230	1310	1290	1270	1250	1220	1195
	LOW	HEAT		1190	1170	1150	1130	1110	1090
36RME	HIGH	COOL	230	1330	1310	1290	1270	1250	1220
	LOW	HEAT		1200	1185	1170	1150	1130	1110
18RHE	HIGH	COOL	230	740	720	705	685	670	650
	LOW	HEAT		590	580	570	560	555	545
24RHE	HIGH	COOL	230	1000	980	960	930	905	880
	LOW	HEAT		815	800	785	765	745	725
30RHE	HIGH	COOL	230	1290	1270	1250	1220	1195	1170
	LOW	HEAT		1170	1150	1130	1110	1090	1070
36RHE	HIGH	COOL	230	1310	1290	1270	1250	1220	1195
	LOW	HEAT		1185	1170	1150	1130	1110	1090

Dry coil data, for wet coil CFM deduct 0.10 from static pressure shown.

PERFORMANCE DATA

UNIT MODEL		NOM. CFM	(1) NOM. COOLING BTUH	HEATING CAPACITY				TOTAL AMPS		MIN. CIR. AMPACITY		(3) MAX. FUSE	
				KW		BTUH							
				240V	208V	240V	208V	240V	208V	240V	208V		
18RME 18RHE & 24RME 24RHE	0-240	600	18000	0	0	0	0	1.5	1.4				
	3-240			3	2.3	10,200	7,800	14	11	20	18	20	20
	4-240			4	3.0	13,600	10,200	18	16	25	22	25	25
	5-240			5	3.8	17,000	13,000	22	20	30	27	30	30
	6-240			6	4.5	20,500	15,300	26	23	35	31	35	35
24RME 24RHE	8-240	800	24000	8	6.0	27,300	20,500	35	30	47	40	50	40
	10-240			10	7.5	34,100	25,600	43	37	56	49	60	50
30RME 30RHE & 36RME 36RHE	0-240	1000	30000	0	0	0	0	2.5	2.3				
	3-240			3	2.3	10,200	7,800	15	14	20	18	20	20
	4-240			4	3.0	13,600	10,200	19	17	25	22	25	25
	5-240			5	3.8	17,000	13,000	24	21	30	27	30	30
	6-240			6	4.5	20,500	15,300	28	25	35	31	35	35
	8-240	1200	36000	8	6.0	27,300	20,500	36	32	47	40	50	40
	10-240			10	7.5	34,100	25,600	45	39	56	49	60	50
	15-240			(2) 15	11.3	51,100	38,500	65	57	82	71	90	80

(1) Model RME — Nom. cooling at 45° evap. temp.
Model RHE — Nom. cooling at 50° evap. temp.

(2) 15 KW units have factory installed fuses.
(3) Max. fuse or type HACR circuit breaker.

Wall Mount Economaster . . .
so easy to install!

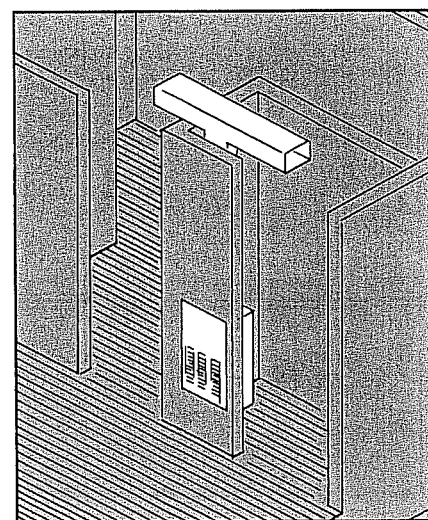
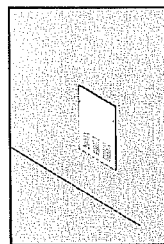
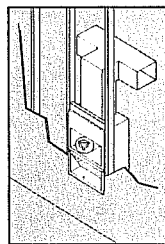
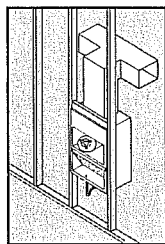
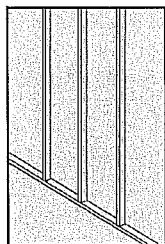

DIMENSIONAL DATA

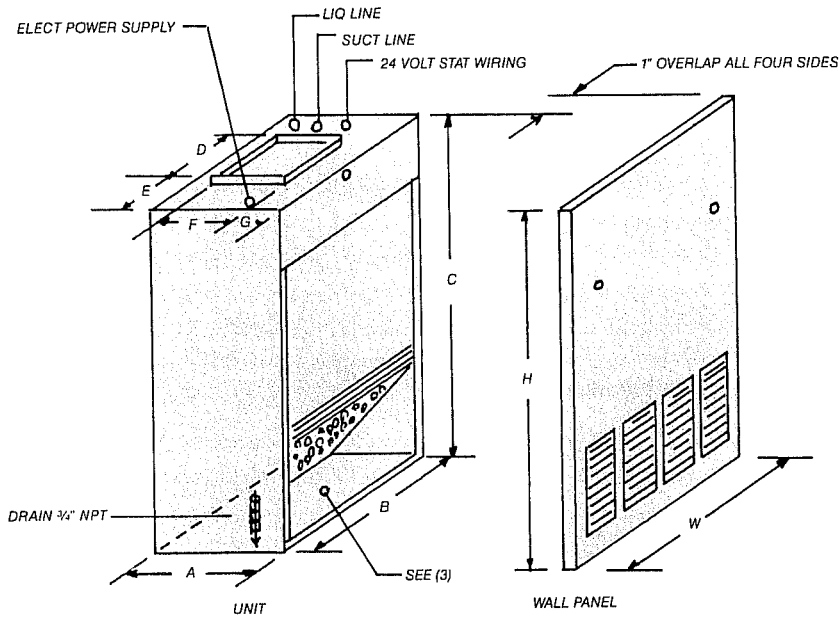

NOTES:

- (1) Approved for installation with 0" clearance to combustible material.
- (2) Condensate drain exits out of bottom of drain pan.
- (3) Removable bottom panel offers simple, easy access to drain connection.

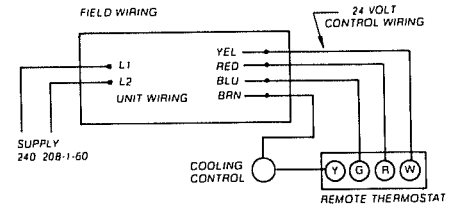

PHYSICAL DIMENSIONS										
MODEL	A	B	C	D	E	F	G	FILTER SIZE	LIQUID LINE	SUCTION LINE
18RME 18RHE	18 1/8"	19 1/8"	41 1/8"	12 1/2"	4"	10 1/2"	5 1/4"	18x20x1	3/8" O.D.	3/4" O.D.
24RME 24RHE	18 1/8"	22 1/8"	41 1/8"	12 1/2"	4"	10 1/2"	5 1/8"	20x20x1	3/8" O.D.	5/8" O.D.
30RME 30RHE	21 1/8"	28 1/8"	45 1/8"	12 1/2"	6 3/8"	12"	5 1/8"	20x25x1	3/8" O.D.	3/4" O.D.
36RME 36RHE	21 1/8"	28 1/8"	45 1/8"	12 1/2"	6 3/8"	12"	5 1/8"	20x25x1	3/8" O.D.	3/4" O.D.

All technical specifications subject to change without notice.



WALL PANEL DIMENSIONS			
WALL PANEL PART NO.	USED ON UNIT MODEL	SIZE W x H	TYPE
920	18RME/RHE	21 1/2 x 43 1/2	LOUVERED
920-1	18RME/RHE	21 1/2 x 43 1/2	NON-LOUVERED
921	24RME/RHE	24 x 43 1/2	LOUVERED
921-1	24RME/RHE	24 x 43 1/2	NON-LOUVERED
922	30&36RME/RHE	30 x 47	LOUVERED
922-1	30&36RME/RHE	30 x 47	NON-LOUVERED
FLUSH PANEL DIMENSIONS (FOR CLOSET APPLICATION)			
920-2	18RME/RHE	B x C	SOLID
921-2	24RME/RHE	B x C	SOLID
922-2	30&36RME/RHE	B x C	SOLID

- (1) All units are furnished standard with the louvered wall panel. If non-louvered panel is required, order must specify.
- (2) Flush mount doors are available so unit may be installed as a vertical closet unit. Consult factory for details.



FIRST CO. 8273 Moberly Lane Dallas, Texas 75227 (214) 388-5751